

KRFN

- narrow terminals for stranded
and flexible conductors 50 - 240 mm²



Product catalogue

KRFN



System Elpress

When crimping in advanced applications it is essential that the crimping system is a high performance and reliable system. In general Elpress has developed a wide range of products specialized for these applications and we offer a concept for demanding high quality applications which consists of four elements, certification, academy, consulting and service.

Certification

For Elpress, crimping is a system method. The system consist of a terminal, a crimping tool, a cable and a trained operator all working in harmony. If some of these elements are left out there is a decrease in functionality for the end user which effects the final installation.



Tests

The KRFN-terminal crimped with Elpress tool is a combination tested in accordance with the electrical standard IEC 61238:1. This is the most widely accepted test standard with a qualified evaluation of performance stability.



Marking on Elpress Cu-connectors

For quality assurance Elpress have a marking system. It shows logotype (essential to know the producer), conductor area and id-number for crimp die to be used. This system enables final inspection of proper die use as the die number is automatically imprinted by the die on the crimped barrel.

Marking of tube terminals
22 (on the terminal neck)
ID-no. for the hexagonal die
(Elpress logo) 150-12 (on the palm)
150 = Cu-conductor area, mm ²
12 = hole for screw M12
F = KRFN



Production quality assurance

It is essential to have simple means of identifying correct crimp procedures and results while working. With the Elpress system the dies leave an imprint on the crimped barrel surface showing the dies identification. This enables a direct and easy inspection if proper tools have been used. For all crimps a crimp height limit is given to make an easy check of proper tool function by means of a caliper or a gauge.

Assured results

When you work with Elpress crimp system and follow the instructions for this system, you get results which have been tested to well established standards and requirements. This is your way of getting assured results in production work.



Consulting

Elpress have high technical personal which can consult you in different questions concerning crimping technology. We also have our own laboratory which can perform mechanical, electrical and environmental tests upon your request.



Academy

To ensure that the operators have the detailed know-how that is the base for long term quality. Elpress runs theoretical and practical training sessions resulting in certification of the individual operators. These trained operators will have a qualified level in regard to practical work procedures as well as the precautions that ensure proper results.

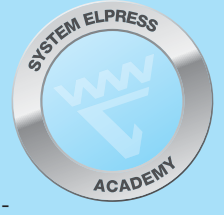

Service

With Elpress service agreements you ensure enhanced equipment performance and at the same time reduce the risk of any stoppages in the production. Elpress tools which are certified are calibrated before delivery and you get a certification of the functionality. It is recommended that each tool is sent in for service once a year for continuing high quality of the crimps.



KRFN

- Elpress narrow terminals for stranded and flexible Cu-conductors 50 - 240 mm²



- for both flexible and stranded Cu-conductors
- for narrow spaces
- easy to mount through conduits
- enables pre-assembly
- electrolytic copper, tin plated
- cable inspection hole
- tested according to IEC60228 class 2 and class 5

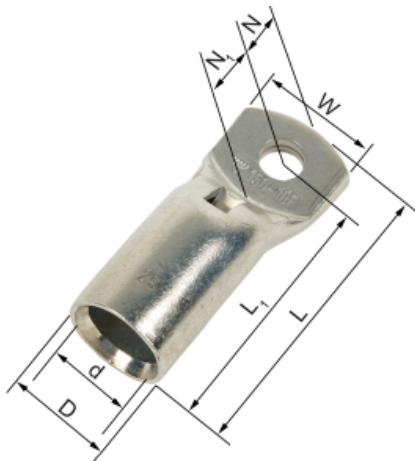

Cat. No.	mm ²	d	D	W	N	N1	L1	L	St/ pack	Rec. system
KRFN50-6	50	11,0	14,5	18	11	12	39	50	100	V600, V1300
KRFN50-8	50	11,0	14,5	18	11	12	39	50	100	V600, V1300
KRFN50-10	50	11,0	14,5	18	11	12	39	50	100	V600, V1300
KRFN70-6	70	13,0	17,0	20	11	12	44	55	50	V600, V1300
KRFN70-8	70	13,0	17,0	20	11	12	44	55	50	V600, V1300
KRFN70-10	70	13,0	17,0	20	11	12	44	55	50	V600, V1300
KRFN95-8	95	15,0	20,0	24	11	12	50	61	50	V600, V1300
KRFN95-10	95	15,0	20,0	24	11	13	51	62	50	V600, V1300
KRFN95-12	95	15,0	20,0	24	12	14	52	64	50	V600, V1300
KRFN120-8	120	17,0	22,0	26	11	12	54	65	50	V1300, V250
KRFN120-10	120	17,0	22,0	26	11	13	55	66	50	V1300, V250
KRFN120-12	120	17,0	22,0	26	12	14	56	68	50	V1300, V250
KRFN150-10	150	19,0	25,0	30	11	13	62	73	50	V1300, V250
KRFN150-12	150	19,0	25,0	30	12	14	63	75	50	V1300, V250
KRFN185-10	185	21,0	27,0	32	11	14	69	80	25	V1300, V250
KRFN185-12	185	21,0	27,0	32	12	15	70	82	25	V1300, V250
KRFN185-16	185	21,0	27,0	32	15	16	71	86	25	V1300, V250
KRFN240A-10	240	22,5	29,0	38	11	16	73	84	50	V1300, V250
KRFN240A-12	240	22,5	29,0	38	12	15	72	84	50	V1300, V250
KRFN240A-16	240	22,5	29,0	38	15	18	75	90	50	V1300, V250



Since 1959 Elpress develops, manufacture and market complete crimping systems for electrical conductor terminations.
Head office and factory are placed in Kramfors, Sweden. Own sales companies in Germany, Denmark and China and we are 160 employees in the Elpress Group. A wide network of qualified representatives support other markets.

