

# Euromold

a Nexans company

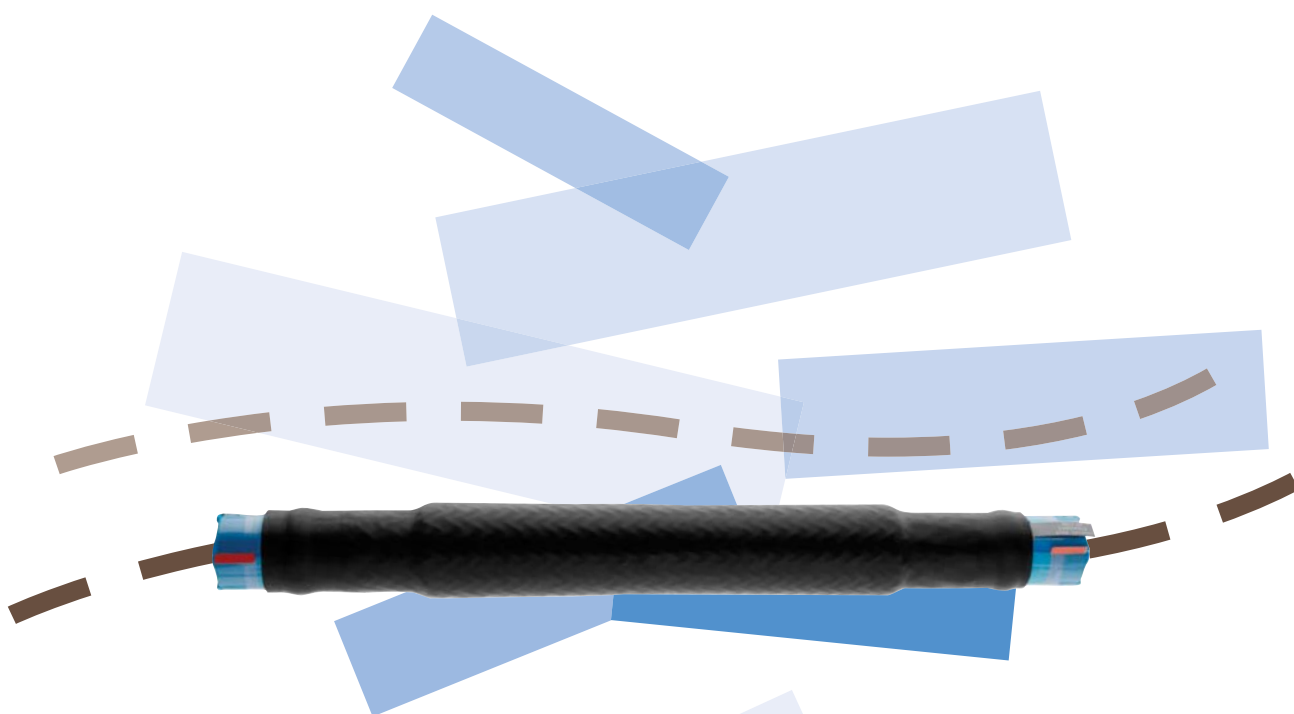

---

Medium voltage joints

Catalogue 2009



### **EUROMOLD**

Euromold is the leading European specialised designer, manufacturer and distributor of prefabricated cable accessories for medium voltage energy distribution. Euromold provides a complete range of accessories for underground cables: pre-moulded EPDM or silicone rubber connectors, terminations and joints for cables and epoxy bushings for transformers and switchgear, as well as a large range of cold-shrinkable terminations and joints from 12 to 42 kV.

Euromold is also the manufacturer of electrical components for the high voltage accessories of the Nexans group.

### **ISO 9001 Certificate**

Since 1992, Euromold's commitment to quality is demonstrated by its ISO 9001 certification.

### **International standards**

All our products meet the International standards like CENELEC HD 629.1, CENELEC EN 50180, IEC 60137, IEEE 386 & 404... or country specifications. Official certificates, CESI, KEMA, ATEX... prove the conformity of our products. Long duration tests of existing or new products are continuously performed in our test fields.

### **Laboratory accreditation**

Since June 2000, Euromold's independent ELAB laboratory obtained the BELTEST accreditation no.192-T-ISO 17025 conform with the European standards for laboratories ISO 17025 for electrical testing of medium voltage cable accessories according to the International standards IEC 61442 and HD 629.

While every care is taken to ensure that the information contained in this publication is correct, no legal responsibility can be accepted for any inaccuracy. Nexans Network Solutions N.V. - Div. Euromold reserves the right to alter or modify the characteristics of its products described in this catalogue as standards and technology evolve.



---

### I Table of contents

- 12CSJ - single core straight joint
- 24CSJ - single core straight joint
- 24CSJ-M - single core straight joint
- 24CSJ-S - single core straight joint
- 36CSJ - single core straight joint
- 36CSSM - single core straight joint
- TT-12CSJ - three core straight joint
- TT-24CSJ - three core straight joint
- TS-12HTJ - hybrid transition joint
- TS-24HTJ - hybrid transition joint
- 12CSJ/STOP - stop joint
- 24CSJ/STOP - stop joint
- 36CSSM/STOP - stop joint
- Enquiry sheet for cable data

## 12CSJ SINGLE CORE STRAIGHT JOINT

Up to 12 kV

### Application

For jointing copper wire screened polymeric cable to be laid in air or directly buried. The product is fully screened and fully submersible.

### Technical characteristics

All joint bodies are tested for AC withstand prior to leaving the factory.

6/10 (12) kV  
6.35/11 (12) kV

### Design

Cold-shrinkable joint comprising:

1. Extruded double layer silicone body.
2. Insulating mastic layer.
3. Field control mastic plate.
4. Overall protective cover.
5. Field control mastic.
6. Water sealing mastic.
7. Copper mesh.
8. Conductor connector (not included in the standard kit).
9. Screen connection with mechanical connector and copper mesh.
10. Traceability tag.

### Specifications and standards

The cold-shrinkable 12CSJ joint meets the requirements of CENELEC HD 629.1.

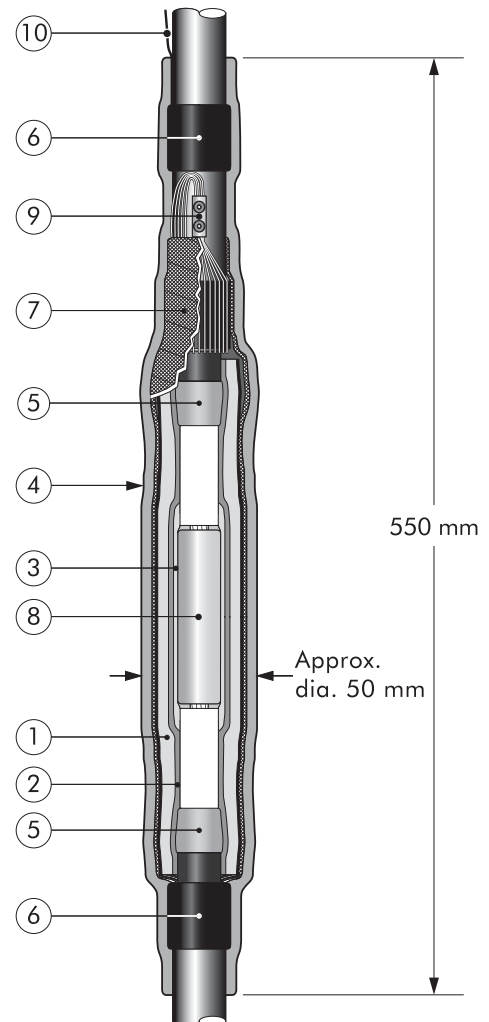

Cold-shrinkable straight joint type	Voltage $U_m$ (kV)	Diameter over core insulation (mm)		Diameter over outer sheath (mm)	Conductor sizes (mm <sup>2</sup> ) (for information only)	
		min	max		min	max
12CSJ-2	12	17	33	46	70	300

## Kit contents

The complete cold-shrinkable joint kit comprises the following components:

The kit also comprises a pulling hook, adhesive tape, water sealing mastic, traceability tag, lubricant, wipers, gloves and installation instructions.

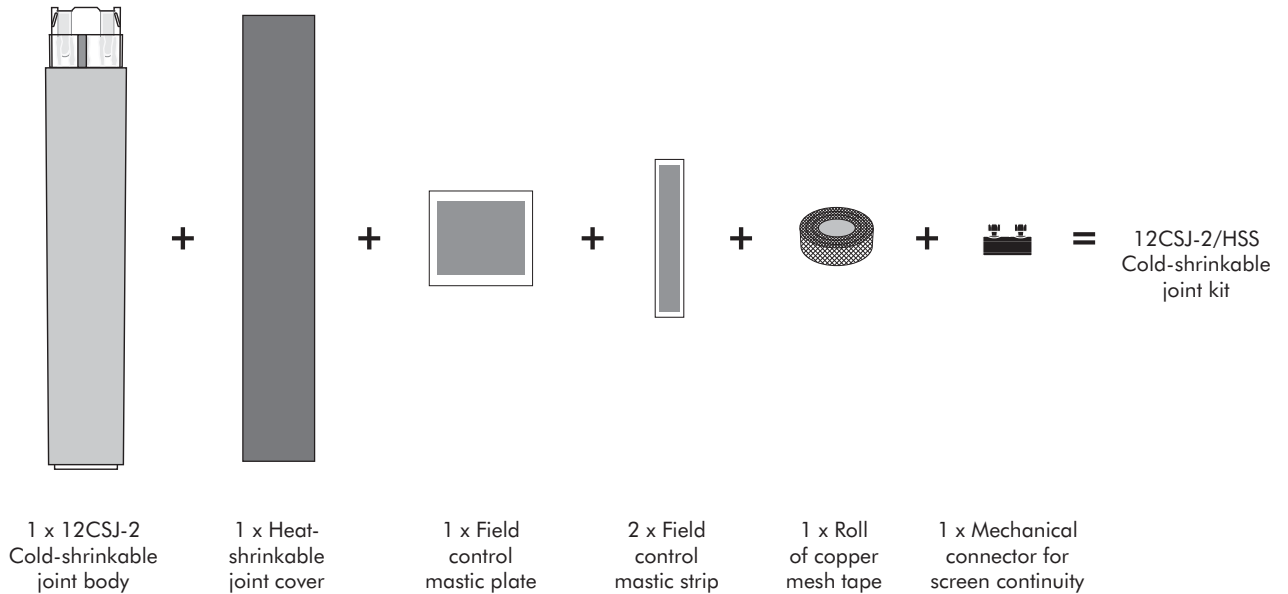

## Ordering instructions

Select the part number corresponding to the cable core insulation diameter.

Ordering part number	Conductor sizes (mm <sup>2</sup> ) (for information only)							Diameter over core insulation (mm)	Diameter over outer sheath (mm)
	70	95	120	150	185	240	300		
12CSJ-2/HSS	<b>12CSJ-2</b>							17 - 33	46 max

### Example:

The copper wire screened cable is 12 kV, 150 mm<sup>2</sup> stranded aluminium with a diameter over core insulation of 22.4 mm. Order a 12CSJ-2/HSS cold-shrinkable joint kit.

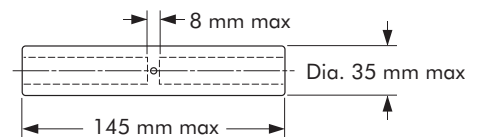

All types of conductor connectors can be used. The conductor connectors must be within the dimensions specified.

For use with copper tape screened cables. Order: -/MT.	Can be supplied for use with fabric tape (graphite) screened cables.	For use with other cable types. Please contact our representative.	For use with three-core cables. See TT-24CSJ.	Can be supplied as a stop joint. Please contact our representative.	Can be supplied with all common types of conductor connectors.

## 24CSJ SINGLE CORE STRAIGHT JOINT

Up to 24 kV

### Application

For jointing copper wire screened polymeric cable to be laid in air or directly buried. The product is fully screened and fully submersible.

### Technical characteristics

All joint bodies are tested for AC withstand prior to leaving the factory.

6/10 (12) kV  
6.35/11 (12) kV  
8.7/15 (17.5) kV  
12/20 (24) kV  
12.7/22 (24) kV

### Design

Cold-shrinkable joint comprising:

1. Extruded triple layer EPDM rubber body.
2. Two layer plate with a semi-conductive and a field control mastic layer.
3. Overall protective EPDM cover.
4. Field control mastic.
5. Water sealing mastic.
6. Copper stocking.
7. Self-adhesive copper tape.
8. Traceability tag.
9. Conductor connector (not included in the standard kit).

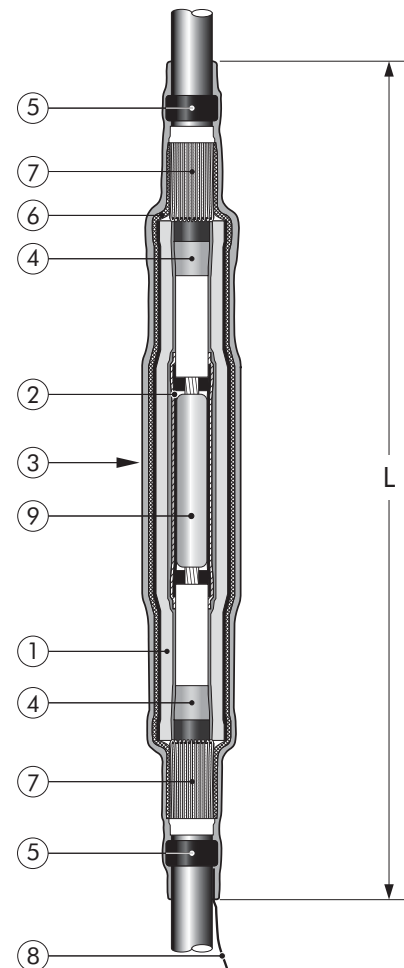

### Specifications and standards

The cold-shrinkable 24CSJ joint meets the requirements of CENELEC HD 629.1.

Cold-shrinkable straight joint type	L (mm)	Voltage $U_m$ (kV)	Diameter over outer sheath (mm)	Diameter over core insulation (mm)		Conductor sizes for 24 kV (mm <sup>2</sup> ) (for information only)	
			max	min	max	min	max
24CSJ-1	750	24	46	18	30	35	185
24CSJ-2	750	24	46	23	33	95	300
24CSJ-3	850	24	57	30	54	240	630

## Kit contents

The complete cold-shrinkable joint kit comprises the following components:

The kit also comprises a pulling hook, adhesive tape, lubricant, wipers, gloves and installation instructions.

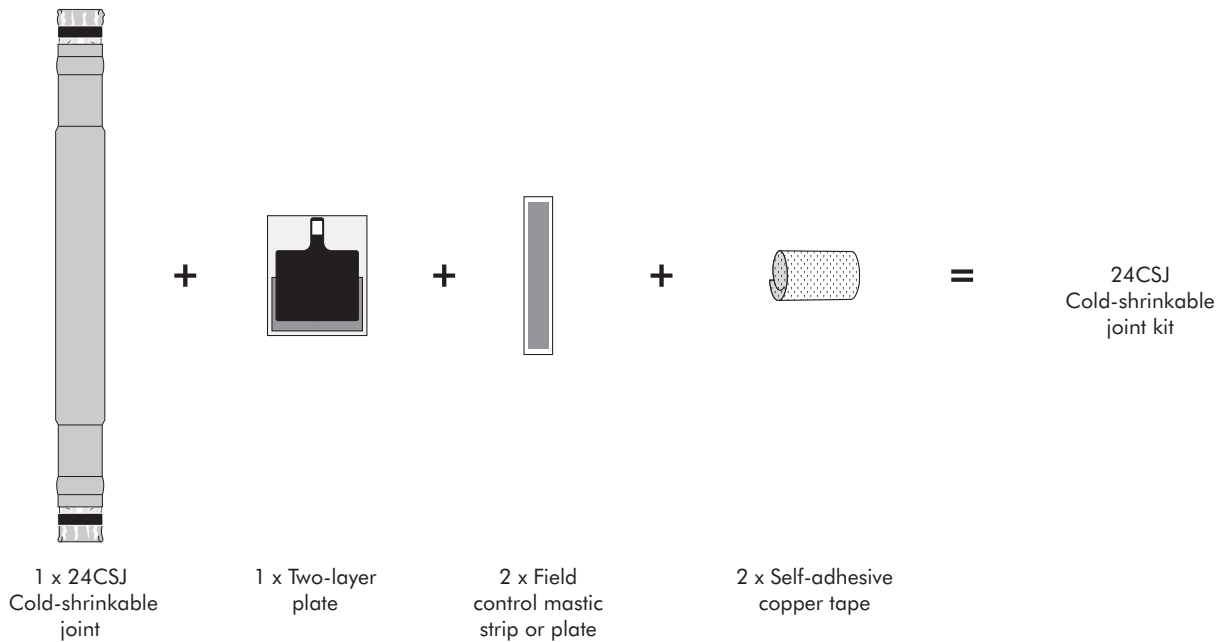

## Ordering instructions

Select the part number corresponding to the cable core insulation diameter.

Ordering part number	Conductor sizes (mm <sup>2</sup> ) (for information only)												Diameter over core insulation (mm)	Diameter over outer sheath (mm)	
	35	50	70	95	120	150	185	240	300	400	500	630			
24CSJ-1	24CSJ-1													18 - 30	46 max
24CSJ-2				24CSJ-2										23 - 33	46 max
24CSJ-3							24CSJ-3							30 - 54	57 max

### Example:

The copper wire screened cable is 24 kV, 120 mm<sup>2</sup> stranded aluminium with a diameter over core insulation of 25.3 mm. Order a 24CSJ-2 cold-shrinkable joint kit.

Joint type	L max (mm)	Dia max (mm)	T max (mm)
24CSJ-1	150	35	8
24CSJ-2	150	35	8
24CSJ-3	280	54	15

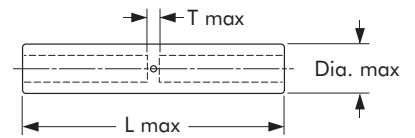

All types of conductor connectors can be used. The conductor connectors must be within the dimensions specified.

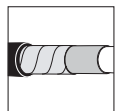

For use with copper tape screened cables.  
Order: -/MT.

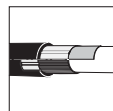

For use with Alupe or C 33-226 cables.  
Please contact our representative.



For use with other cable types.  
Please contact our representative.



For use with three-core cables.  
See TT-24CSJ.

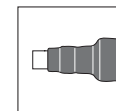

Can be supplied as a stop joint.  
Please contact our representative.

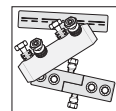

Can be supplied with all common types of conductor connectors.



## 24CSJ-M SINGLE CORE STRAIGHT JOINT WITH MECHANICAL CONNECTOR

Up to 24 kV

### Application

For jointing copper wire screened polymeric cable to be laid in air or directly buried. The product is fully screened and fully submersible.

### Technical characteristics

All joint bodies are tested for AC withstand prior to leaving the factory.

6/10 (12) kV  
6.35/11 (12) kV  
8.7/15 (17.5) kV  
12/20 (24) kV  
12.7/22 (24) kV

### Design

Cold-shrinkable joint comprising:

1. Extruded triple layer EPDM rubber body.
2. Two layer plate with a semi-conductive and a field control mastic layer.
3. Overall protective EPDM cover.
4. Field control mastic.
5. Water sealing mastic.
6. Copper stocking.
7. Self-adhesive copper tape.
8. Traceability tag.
9. Mechanical conductor connector (included in the standard kit).

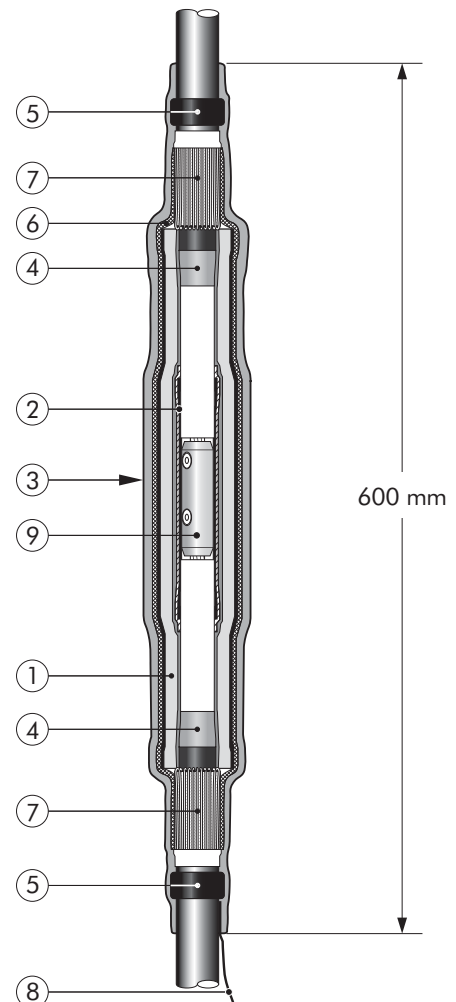

### Specifications and standards

The cold-shrinkable 24CSJ-M joint meets the requirements of CENELEC HD 629.1.

Cold-shrinkable straight joint type	Voltage $U_m$ (kV)	Diameter over outer sheath (mm)	Diameter over core insulation (mm)		Conductor sizes (mm <sup>2</sup> )	
			min	max	min	max
24CSJ-M50-150	24	46 max	18	30	50	150
24CSJ-M95-240	24	46 max	23	33	95	400

## Kit contents

The complete cold-shrinkable joint kit comprises the following components:

The kit also comprises a pulling hook, adhesive tape, lubricant, wipers, gloves and installation instructions.

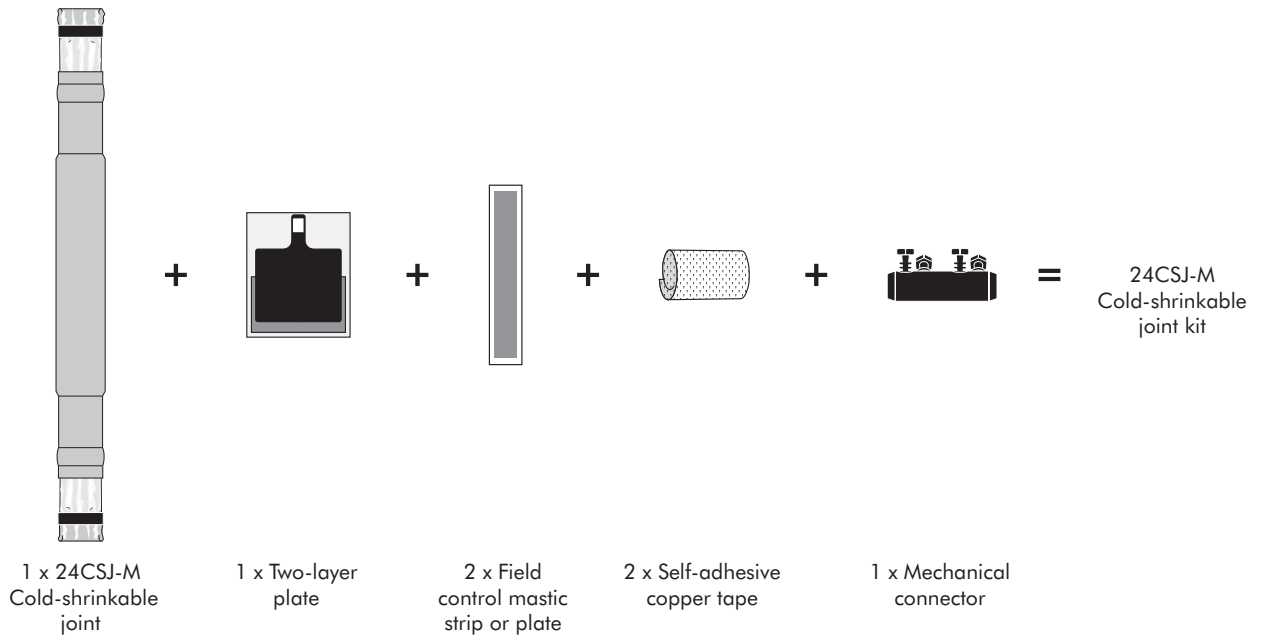

## Ordering instructions

Select the part number corresponding to the voltage class and conductor size.

Ordering part number	Voltage (Um) (kV)	Conductor sizes (mm <sup>2</sup> )							Diameter over core insulation (mm)	Diameter over outer sheath (mm)
		50	70	95	120	150	185	240		
24CSJ-M50-150	24	24CSJ-M50-150							18 - 30	46 max
24CSJ-M95-240	24			24CSJ-M95-240					23 - 33	46 max

### Example:

The copper wire screened cable is 24 kV, 150 mm<sup>2</sup> stranded aluminium with a diameter over core insulation of 26.5 mm. Order a 24CSJ-M95-240 cold-shrinkable joint kit.

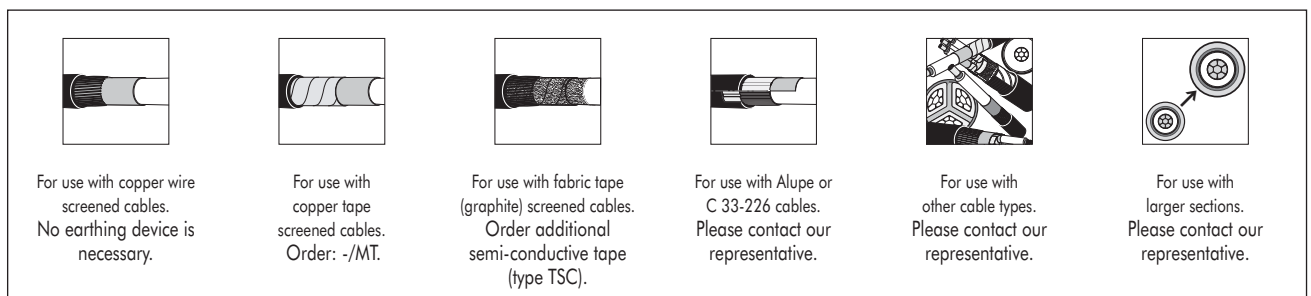

## 24CSJ-S SINGLE CORE STRAIGHT JOINT WITH MECHANICAL CONNECTOR

Up to 24 kV

### Application

For jointing copper wire screened polymeric cable to be laid in air or directly buried. The product is fully screened and fully submersible. This product can be installed where installation space is limited (min 1 meter).

### Technical characteristics

All joint bodies are tested for AC withstand prior to leaving the factory.

6/10 (12) kV  
6.35/11 (12) kV  
8.7/15 (17.5) kV  
12/20 (24) kV  
12.7/22 (24) kV

### Design

Cold-shrinkable joint comprising:

1. Extruded triple layer EPDM rubber body.
2. Two layer plate with a semi-conductive and a field control mastic layer.
3. Overall protective EPDM cover.
4. Field control mastic.
5. Water sealing mastic.
6. Copper stocking.
7. Self-adhesive copper tape.
8. Traceability tag.
9. Mechanical conductor connector (included in the standard kit).

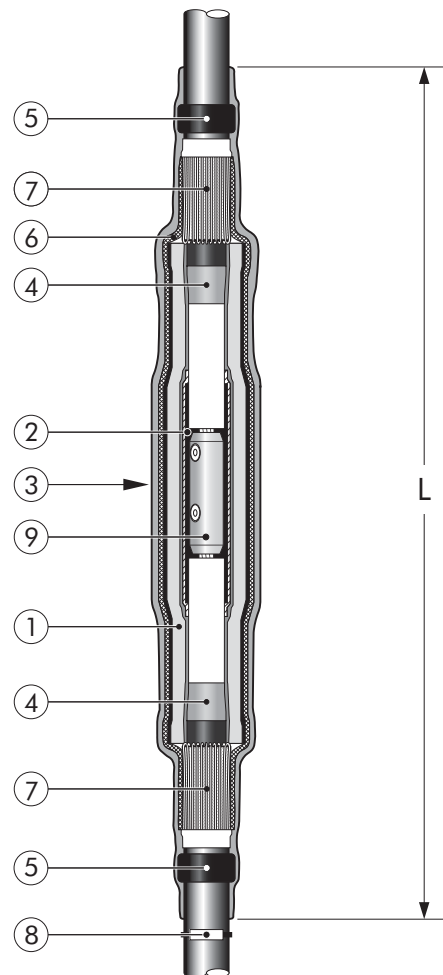

### Specifications and standards

The cold-shrinkable 24CSJ-S joint meets the requirements of CENELEC HD 629.1.

Cold-shrinkable straight joint type	L (mm)	Voltage $U_m$ (kV)	Diameter over outer sheath (mm)	Diameter over core insulation (mm)		Conductor sizes for 24 kV (mm <sup>2</sup> ) (for information only)	
				min	max	min	max
24CSJ-S1	650	24	48	18	25	35	95
24CSJ-S2	650	24	48	23	36	95	300

12/2009

## Kit contents

The complete cold-shrinkable joint kit comprises the following components:

The kit also comprises a installation hook, adhesive tape, lubricant, wipers, gloves, template, white pencil and installation instructions.

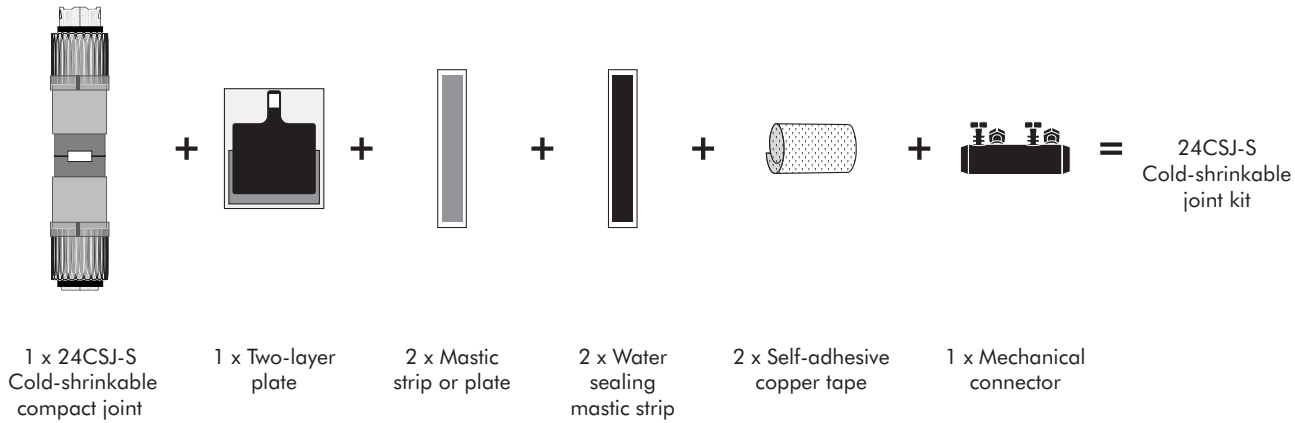



## Ordering instructions

Select the part number corresponding to the cable core insulation diameter.

Ordering part number	Conductor sizes (mm <sup>2</sup> ) (for information only)									Diameter over core insulation (mm)	Diameter over outer sheath (mm)
	35	50	70	95	120	150	185	240	300		
24CSJ-S1	<b>24CSJ-S1</b>									18 - 25	48 max
24CSJ-S2				<b>24CSJ-S2</b>						23 - 33	48 max

### Example:

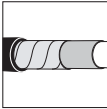
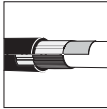
The copper wire screened cable is 24 kV, 120 mm<sup>2</sup> stranded aluminium with a diameter over core insulation of 25.3 mm. Order a 24CSJ-S2 cold-shrinkable joint kit.

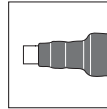
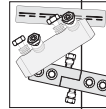
					
For use with copper tape screened cables. Order: -/MT.	For use with Alupe or C 33-226 cables. Please contact our representative.	For use with other cable types. Please contact our representative.	For use with three-core cables. See TT-24CSJ.	Can be supplied as a stop joint. Please contact our representative.	Can be supplied with all common types of conductor connectors.

## 36CSJ SINGLE CORE STRAIGHT JOINT

Up to 36 kV

### Application

For jointing copper wire screened polymeric cable to be laid in air or directly buried. The product is fully screened and fully submersible.

### Technical characteristics

All joint bodies are tested for AC withstand prior to leaving the factory.

18/30 (36) kV  
19/33 (36) kV

### Design

Cold-shrinkable joint comprising:

1. Extruded triple layer EPDM rubber body.
2. Semi-conductive tape embedded in field control mastic.
3. Overall protective EPDM cover.
4. Field control mastic.
5. Water sealing mastic.
6. Copper stocking.
7. Self-adhesive copper tape.
8. Traceability tag.
9. Conductor connector (not included in the standard kit).

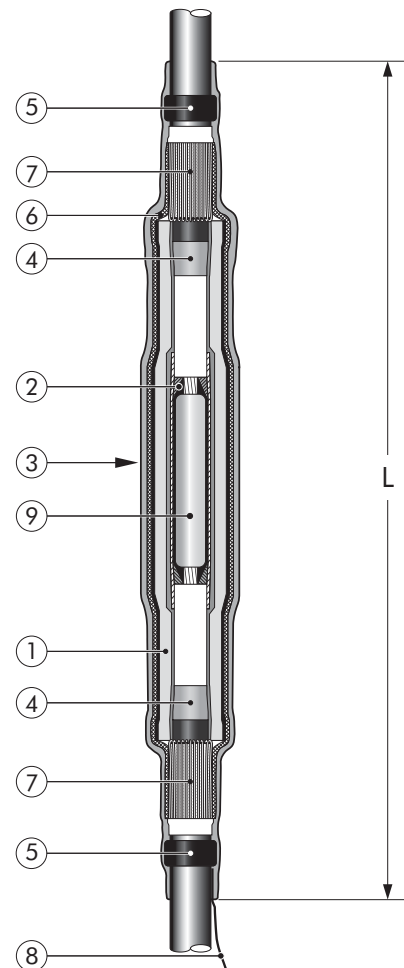

### Specifications and standards

The cold-shrinkable 36CSJ joint meets the requirements of CENELEC HD 629.1.

Cold-shrinkable straight joint type	L (mm)	Voltage $U_m$ (kV)	Diameter over outer sheath (mm)		Diameter over core insulation (mm)		Conductor sizes for 36 kV (mm <sup>2</sup> ) (for information only)	
			max	min	min	max	min	max
36CSJ-2	750	36	48	23	36	50	240	

## Kit contents

The complete cold-shrinkable joint kit comprises the following components:

The kit also comprises a pulling hook, adhesive tape, lubricant, wipers, gloves, template, white pencil and installation instructions.

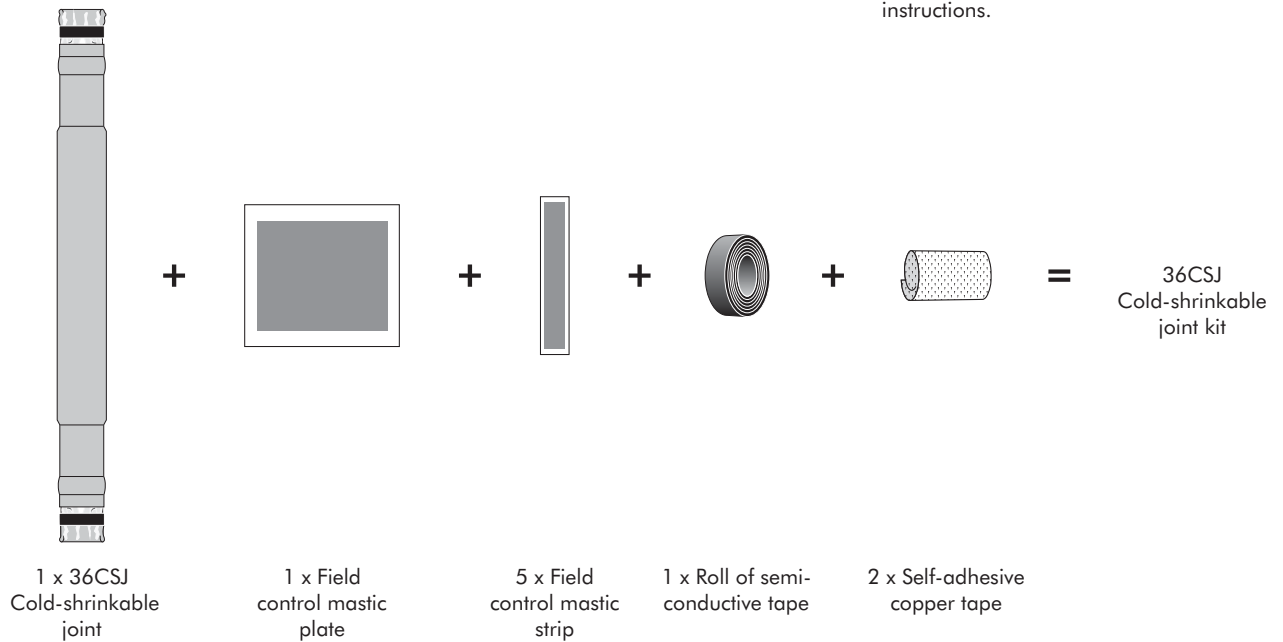

## Ordering instructions

Select the part number corresponding to the cable core insulation diameter.



Ordering part number	Conductor sizes (mm <sup>2</sup> ) (for information only)							Diameter over core insulation (mm)	Diameter over outer sheath (mm)
	50	70	95	120	150	185	240		
36CSJ-2	<b>36CSJ-2</b>							23 - 36	48 max

### Example:

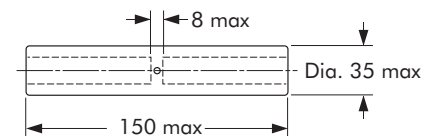
The copper wire screened cable is 36 kV, 150 mm<sup>2</sup> stranded aluminium with a diameter over core insulation of 32.1 mm. Order a 36CSJ-2 cold-shrinkable joint kit.

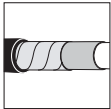
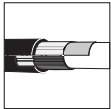

All types of conductor connectors can be used. The conductor connectors must be within the dimensions specified.

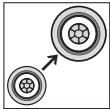
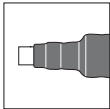
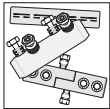
					
For use with copper tape screened cables. Order: -/MT.	For use with Alupe or C 33-226 cables. Please contact our representative.	For use with other cable types. Please contact our representative.	For use with larger sections. Please contact our representative.	Can be supplied as a stop joint. Please contact our representative.	Can be supplied with all common types of conductor connectors.

## 36CSSM SINGLE CORE STRAIGHT JOINT

Up to 42 kV

### Application

For jointing copper wire screened polymeric cable to be laid in air or directly buried. The product is fully screened and fully submersible.

### Technical characteristics

All joint bodies are tested for AC withstand prior to leaving the factory.

18/30 (36) kV  
19/33 (36) kV  
20.8/36 (41.5) kV

### Design

Cold-shrinkable joint comprising:

1. Moulded silicone joint body.
2. Semi-conductive plate.
3. Overall protective cover.
4. Water sealing mastic.
5. Copper stocking or mesh.
6. Self-adhesive copper tape.
7. Traceability tag.
8. Conductor connector (not included in the standard kit).

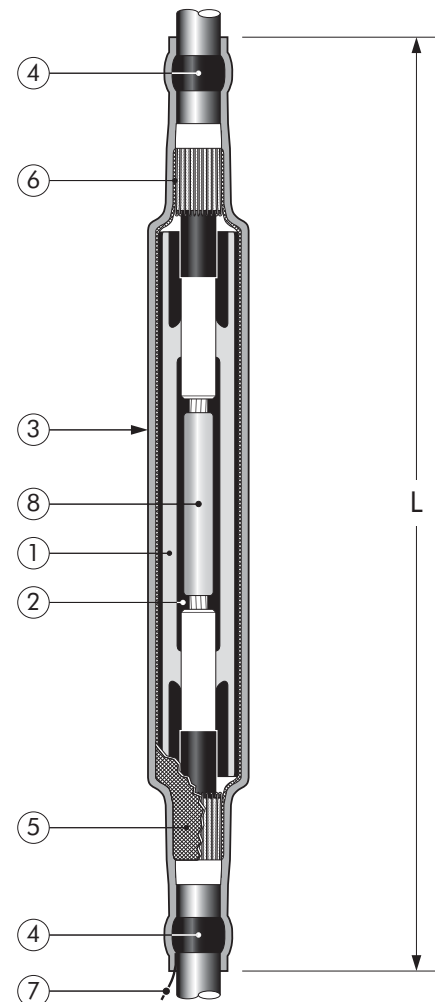

### Specifications and standards

The cold-shrinkable 36CSSM joint meets the requirements of CENELEC HD 629.1.

Cold-shrinkable straight joint type	Cover type	L (mm)	Voltage $U_m$ (kV)	Dia. over outer sheath (mm)		Dia. over core insulation (mm)		Conductor sizes for 36 kV (mm <sup>2</sup> ) (for information only)	
				max	min	max	min	max	
36CSSM-2/CSC	Cold-shrinkable	750	42	48	27	40	50	240	
36CSSM-3/CSC	Cold-shrinkable	850	42	57	37	50	300	500	
36CSSM-3/HSS	Heat-shrinkable	850	42	75	37	60	300	800	

## Kit contents

The complete cold-shrinkable joint kit comprises the following components:

The kit also comprises a pulling hook, template, adhesive tape, lubricant, wipers, white pencil, gloves and installation instructions.

For 36CSSM-3/HSS, a heat-shrinkable cover is supplied.

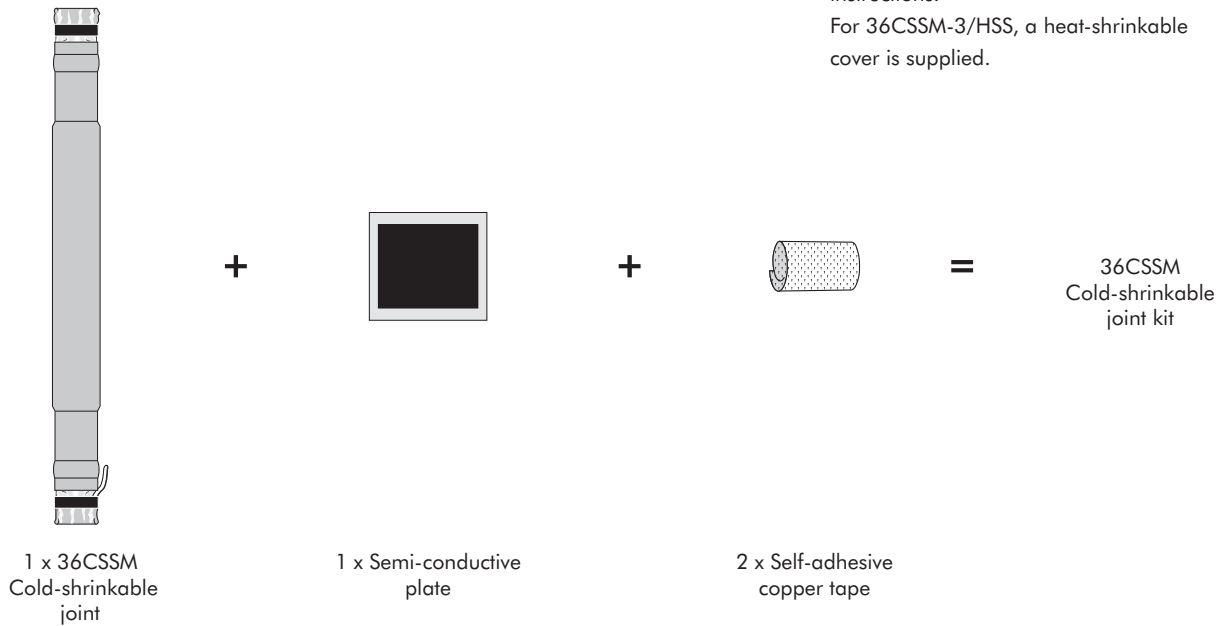

## Ordering instructions

Select the part number corresponding to the cable core insulation diameter.

Ordering part number	Conductor sizes (mm <sup>2</sup> )											Dia. over core insulation (mm)	Dia. over outer sheath (mm)	
	50	70	95	120	150	185	240	300	400	500	630			800
36CSSM-2/CSC	36CSSM-2/CSC												25 - 40	48 max
36CSSM-3/CSC							36CSSM-3/CSC					37 - 50	57 max	
36CSSM-3/HSS							36CSSM-3/HSS					37 - 60	75 max	

### Example:

The copper wire screened cable is 36 kV, 150 mm<sup>2</sup> stranded aluminium with a diameter over core insulation of 32.0 mm. Order a 36CSSM-2/CSC cold-shrinkable joint kit.

All types of conductor connectors can be used. The conductor connectors must be within the dimensions specified.

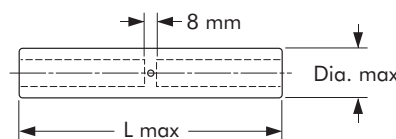

Joint type	L max (mm)	Dia. max (mm)
36CSSM-2	155	35
36CSSM-3	240	60
	215 (if dia. over insulation >50 mm.)	

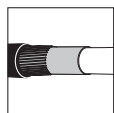

For use with copper wire screened cables. No earthing device is necessary.

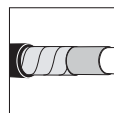

Can be supplied for use with copper tape screened cables.

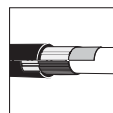

Can be supplied for use with C 33-226 cables.



For use with other cable types. Please contact our representative.

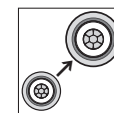

For use with larger sections. Please contact our representative.

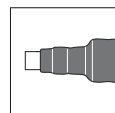

Can be supplied as a stop joint. Please contact our representative.



## TT-12CSJ THREE-CORE STRAIGHT JOINT

Up to 12 kV

### Application

For jointing three-core polymeric cables to be directly buried. The product is fully screened and fully submersible.

### Technical characteristics

- All joint bodies are tested for AC withstand prior to leaving the factory.
- All different types of armouring and screen connection systems are possible.
- Extra water sealing system available.

6/10 (12) kV  
6.35/11 (12) kV

### Design

The joint comprises:

1. Extruded double layer silicone body.
2. Field control mastic plate.
3. Field control mastic.
4. Copper stocking or mesh.
5. Conductor connector (not included in the standard kit).
6. Screen and armour continuity (adapted to the specific needs).
7. Overall protective cover, can be:
  - heat-shrinkable or
  - poured resin or
  - resin injected tape.
8. Water sealing system (if required).

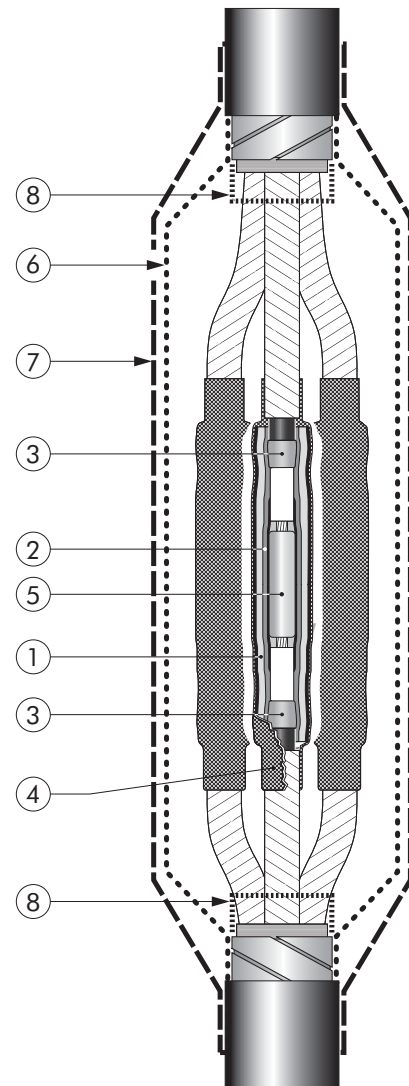

### Specifications and standards

This joint meets the requirements of CENELEC HD 629.1.

Cold-shrinkable straight joint type	Voltage $U_m$ (kV)	Diameter over core insulation (mm)		Conductor sizes (mm <sup>2</sup> ) (for information only)	
		min	max	min	max
TT-12CSJ-2	12	17	33	70	300

## Kit contents

The complete cold-shrinkable joint kit comprises the following components:

The kit also comprises a pulling hook, adhesive tape, roll springs, water sealing mastic, lubricant, wipers and installation instructions.

Depending on the type of screen, the cable armour and the outer protection required, the necessary components will be included in the kit.

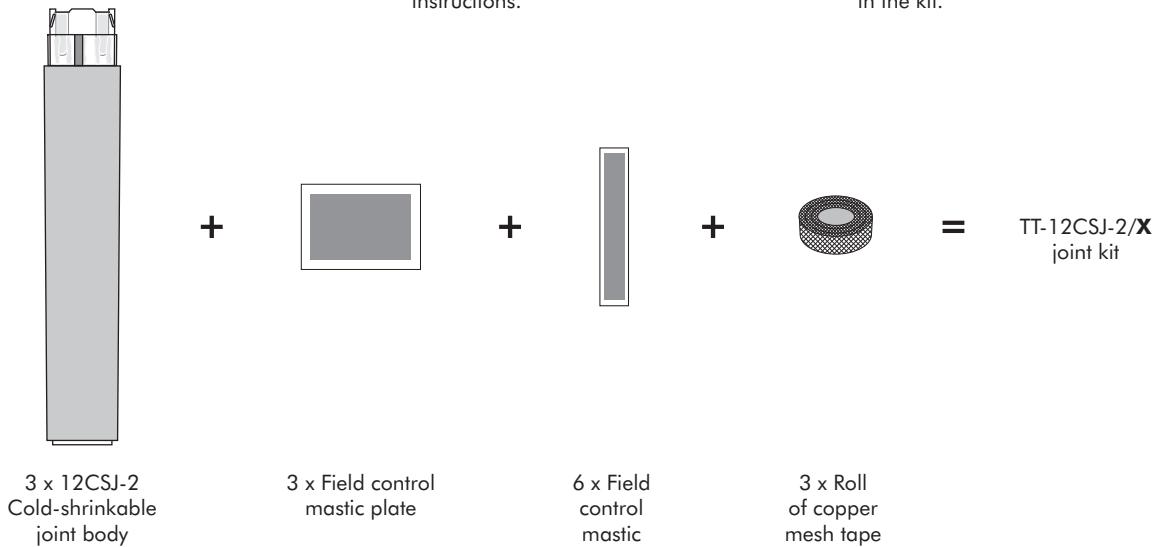

## Ordering instructions

To order the three-core straight joint, specify TT-12CSJ-2 and add the code corresponding to the type of cover required.

Please indicate the required earth connection and provide the cable data sheet for screening and/or armour connection solution (see Enquiry sheet p. 26).

Ordering part number	Conductor sizes (mm <sup>2</sup> ) (for information only)							Diameter over core insulation (mm)	
	70	95	120	150	185	240	300	min	max
TT-12CSJ-2/X	TT-12CSJ-2/X							17	33

### Example:

The three-core cable with individual copper tape screen is 12 kV, 3 x 150 mm<sup>2</sup> stranded aluminium, without armour (with a diameter over core insulation of 23.3 mm and over outer sheath 59.8 mm) and a tape injected resin cover is required.

Order a TT-12CSJ-2/TIR joint kit.

Table X

Cover type	Description
/HSS	The joint will be supplied with a heat-shrinkable cover
/TIR	The joint will be supplied with a taped injected resin cover
/PBR	The joint will be supplied with a poured resin box cover

All types of conductor connectors can be used. The conductor connectors must be within the dimensions specified. If the conductor connector does not meet these requirements, please contact our representative.

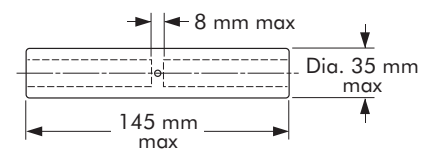

For use with other cable types. Please contact our representative.

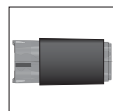

A special water sealing system is available. Please contact our representative.

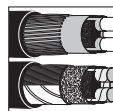

Different armour connections are available. Please contact our representative.

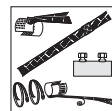

Different types of screen continuity kits can be supplied. Please contact our representative.



For transition from three core to single core XLPE cables. Please contact our representative.

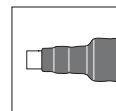

Can be supplied as a stop joint. Please contact our representative.

## TT-24CSJ THREE CORE STRAIGHT JOINT

Up to 24 kV

### Application

For jointing three core polymeric cables to be directly buried. The product is fully screened and fully submersible.

### Technical characteristics

- All joint bodies are tested for AC withstand prior to leaving the factory.
- All different types of armouring and screen connection systems are possible.
- Extra water sealing system available.

6/10 (12) kV  
6.35/11 (12) kV  
8.7/15 (17.5) kV  
12/20 (24) kV  
12.7/22 (24) kV

### Design

The joint comprises:

1. Extruded triple layer EPDM rubber body.
2. Two layer plate with a semi-conductive and a field control mastic layer.
3. Field control mastic.
4. Copper stocking or mesh.
5. Conductor connector (not included in the standard kit).
6. Roll springs.
7. Screen and armour continuity (adapted to the specific needs).
8. Overall protective cover, can be:
  - heat-shrinkable or
  - poured resin or
  - resin injected tape.
9. Water sealing system (if required).

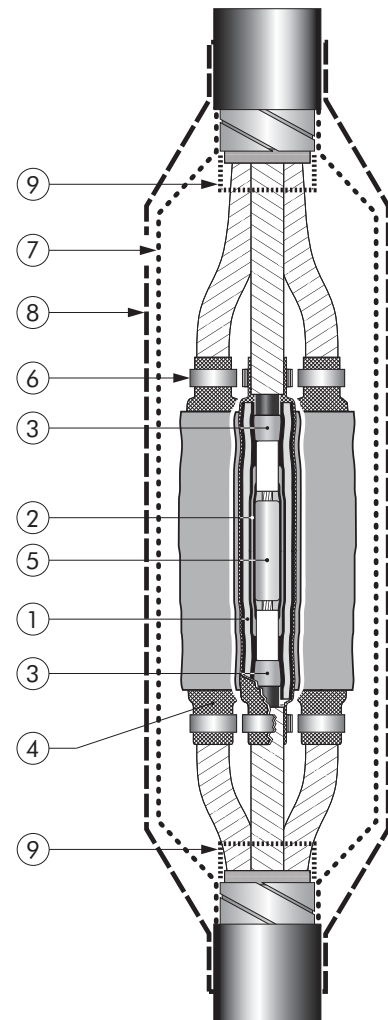

### Specifications and standards

This joint meets the requirements of CENELEC HD 629.1.

Cold-shrinkable straight joint type	Voltage $U_m$ (kV)	Diameter over core insulation (mm)		Conductor sizes for 24 kV (mm <sup>2</sup> ) (for information only)	
		min	max	min	max
TT-24CSJ-1	24	18	30	35	185
TT-24CSJ-2	24	23	33	95	300

## Kit contents

The complete cold-shrinkable joint kit comprises the following components:

The kit also comprises a pulling hook, adhesive tape, roll springs, water sealing mastic, lubricant, wipers, gloves and installation instructions.

Depending on the type of the cable armour and the outer protection required, other components will be included in the kit.

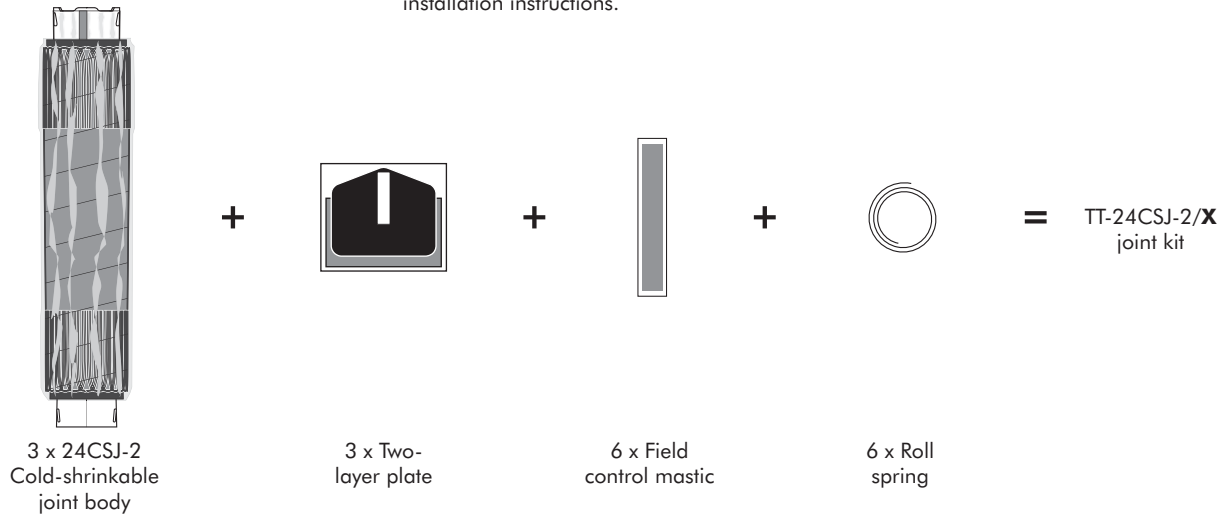

## Ordering instructions

Make sure cable outer sheath and core insulation diameters correspond to the range shown in the table below.

Select the part number and add the code corresponding to the type of cover required. Please indicate the required earth connection and provide

the cable data sheet for screening and/or armour connection solution (see Enquiry sheet p. 26).

Ordering part number	Conductor sizes (mm <sup>2</sup> ) (for information only)									Diameter over core insulation (mm)	Diameter over outer sheath (mm)
	35	50	70	95	120	150	185	240	300		
TT-24CSJ-1/X	TT-24CSJ-1/X									18 - 30	80 max
TT-24CSJ-2/X	TT-24CSJ-2/X									23 - 33	80 max

### Example:

The three core cable with individual copper tape screen is 24 kV, 3 x 120 mm<sup>2</sup> stranded aluminium, without armour (with a diameter over core insulation of 26.6 mm and over outer sheath 67.4 mm) and a heat-shrinkable cover is required. Order a TT-24CSJ-2/HSS joint kit.

Table X

Cover type	Description
/HSS	The joint will be supplied with a heat-shrinkable cover
/TIR	The joint will be supplied with a taped injected resin cover
/PBR	The joint will be supplied with a poured resin box cover

All types of conductor connectors can be used. The conductor connectors must be within the dimensions specified.

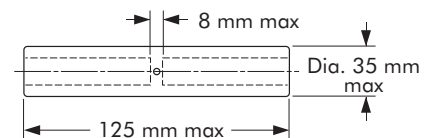

For use with other cable types. Please contact our representative.	A special water sealing system is available. Please contact our representative.	Different armour connections are available. Please contact our representative.	Different types of screen continuity kits can be supplied. Please contact our representative.	Can be supplied as a stop joint. Please contact our representative.	Can be supplied with all common types of conductor connectors.

## TS-12HTJ TRANSITION JOINT

Up to 12 kV

### Application

For jointing three-core paper cables to three single core polymeric cables. This hybrid transition joint combines cold-shrinkable and heat-shrinkable technology. The heat-shrinkable technology is used for re-insulating and oil barrier purposes, the cold-shrinkable technology is used for the actual jointing of the three phases. This transition joint is fully screened and submersible.

### Technical characteristics

- For use with belted and Höchstädter cable (individual screened), both draining and non-draining.
- All different kinds of armouring and screen connection systems are possible.
- A compact design with enhanced water vapour resistance due to a moisture barrier sleeve.

6/10 (12) kV  
6.35/11 (12) kV

### Design

The joint comprises:

1. Extruded double layer silicone body.
2. Field control mastic plate.
3. Protective cover.
4. Field control mastic.
5. Water sealing system, including a barrier sleeve.
6. Copper stocking and mesh.
7. Conductor connector (not included in the standard kit).
8. Heat-shrinkable break-out.
9. Heat-shrinkable semi-conductive tubes.
10. Oil barrier tubes.
11. Trifurcating moisture barrier sleeve.

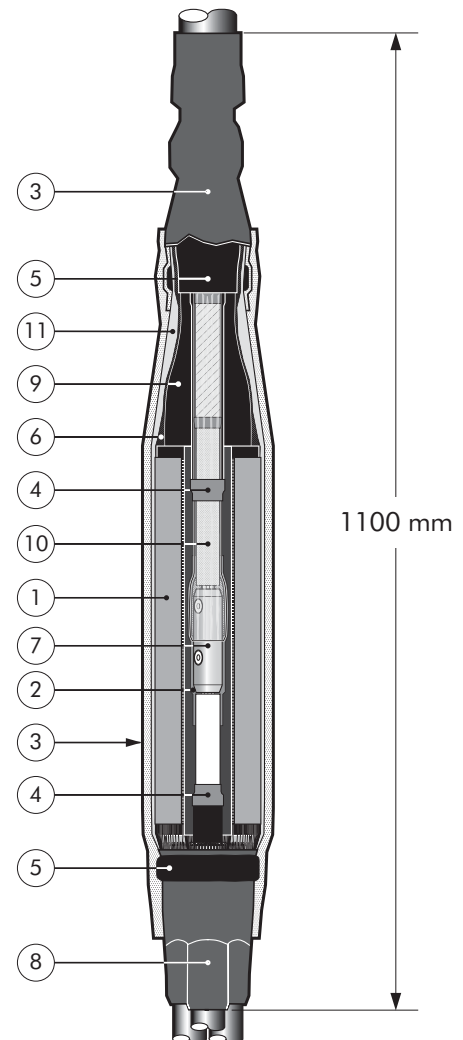

### Specifications and standards

This transition joint meets the requirements of CENELEC HD 629.2.

Cold-shrinkable transition joint type	Dry insulated cable data			Paper insulated cable data			Conductor sizes (mm <sup>2</sup> ) (for information only)	
	Type	Dia. over outer sheath	Dia. over core insulation	Type	Dia. over outer sheath	Dia. over core insulation	min	max
TS-12HTJ	1-core	46 mm max	17 mm min	3-core	65 mm max	16 mm min	50	300

12/2009

## Kit contents

The complete transition joint kit comprises the following components:

The kit also comprises a pulling hook, roll springs, copper flexible braid, connectors for screen connection, semi-conductive tape, field control mastic, adhesive tape, water sealing mastic, lubricant, wipers, gloves and installation instructions.

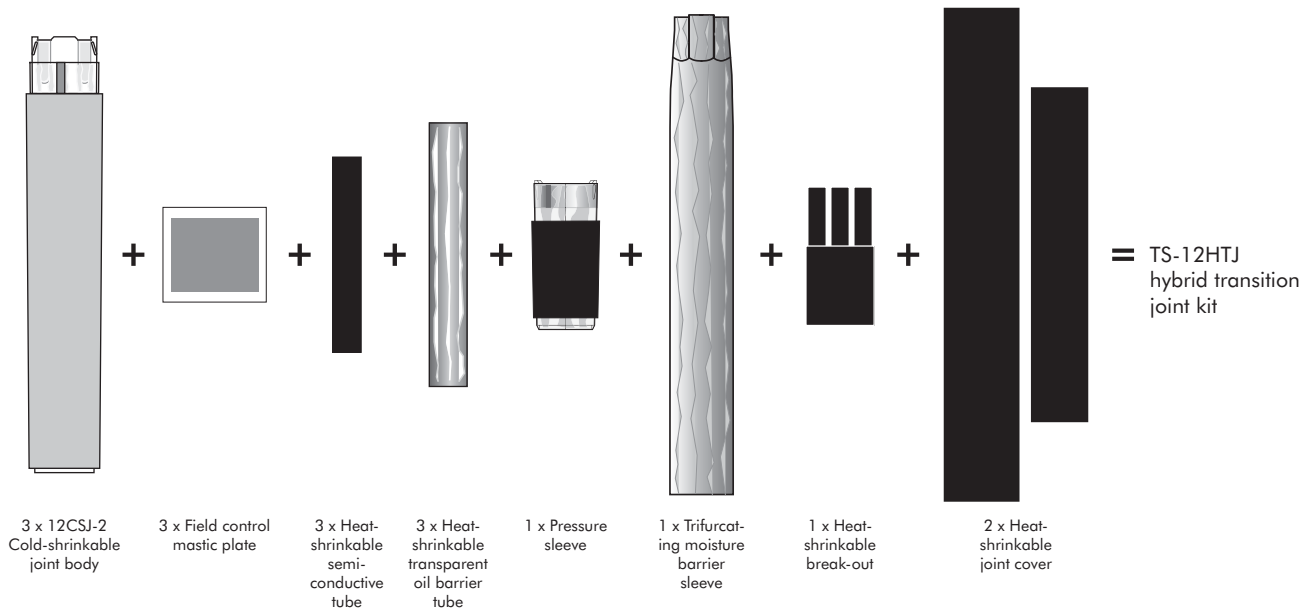

## Ordering instructions

Select the part number and verify the cable dimensions.

Please specify detailed cable information (type of screen and armour - see Enquiry sheet p. 26).

Ordering part number	Conductor sizes (mm <sup>2</sup> )							Diameter over core insulation (mm)
	70	95	120	150	185	240	300	
TS-12HTJ	TS-12HTJ							17 - 33

### Example:

The three core belted cable is 12 kV, 3 x 150 mm<sup>2</sup>, non-draining, without armour and must be jointed to three single core 12 kV, 150 mm<sup>2</sup> XLPE cables with a copper wire screen (with a diameter over core insulation of 22.2 mm). Order a TS-12HTJ transition joint kit.

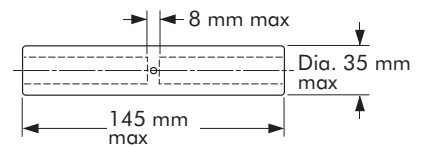

All types of conductor connectors can be used. The conductor connectors must be within the dimensions specified. An oil stop is mandatory for all types of conductor connectors.

For use with copper wire screened cables. No earthing device is necessary.	When jointing cables of different sizes, please contact our representative.	Different armour connections are available. Please contact our representative.	Can be supplied with all common types of conductor connectors.	Different types of screen continuity kits can be supplied. Please contact our representative.	Resin injected and cast resin covers available. Please contact our representative.

## TS-24HTJ TRANSITION JOINT

Up to 24 kV

### Application

For jointing three-core paper cables to three single core polymeric cables. This hybrid transition joint combines cold-shrinkable and heat-shrinkable technology. The heat-shrinkable technology is used for re-insulating and oil barrier purposes, the cold-shrinkable technology is used for the actual jointing of the three phases. This transition joint is fully screened and submersible.

### Technical characteristics

- For use with belted and Höchstädter cable (individual screened), both draining and non-draining.
- All different kinds of armouring and screen connection systems are possible.
- A compact design with enhanced water vapour resistance due to a moisture barrier sleeve.

6/10 (12) kV  
6.35/11 (12) kV  
8.7/15 (17.5) kV  
12/20 (24) kV  
12.7/22 (24) kV

### Design

The joint comprises:

1. Extruded triple layer EPDM rubber body.
2. Two layer plate with a semi-conductive and a field control mastic layer.
3. Protective cover.
4. Field control mastic.
5. Water sealing system, including a barrier sleeve.
6. Copper stocking and mesh.
7. Conductor connector (not included in the standard kit).
8. Heat-shrinkable break-out.
9. Heat-shrinkable semi-conductive tubes.
10. Oil barrier tubes.
11. Trifurcating moisture barrier sleeve.

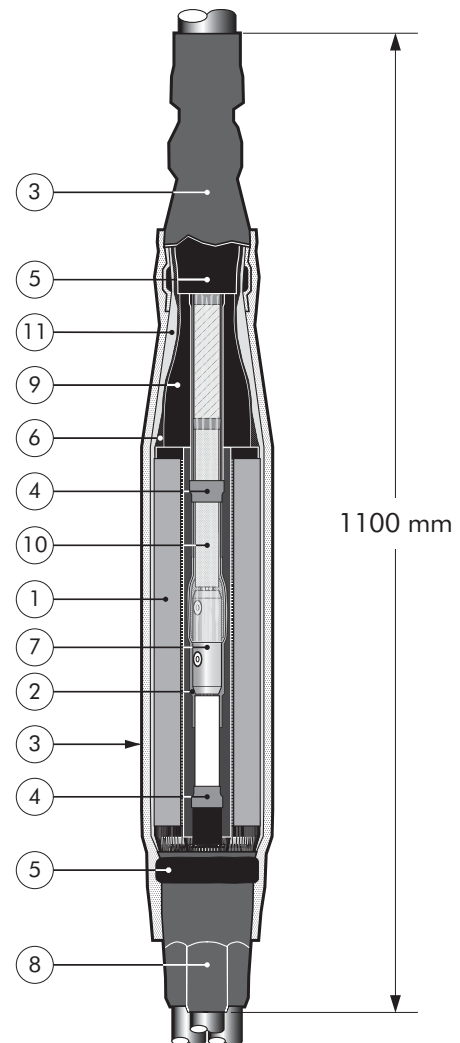

### Specifications and standards

This transition joint meets the requirements of CENELEC HD 629.2.

Cold-shrinkable transition joint type	Dry insulated cable data			Paper insulated cable data			Conductor sizes (mm <sup>2</sup> ) (for information only)	
	Type	Dia. over outer sheath	Dia. over core insulation	Type	Dia. over outer sheath	Dia. over core insulation	min	max
TS-24HTJ-1	1-core	46 mm max	18 mm min	3-core	65 mm max	15 mm min	35	185
TS-24HTJ-2	1-core	46 mm max	23 mm min	3-core	65 mm max	15 mm min	50	300

## Kit contents

The complete transition joint kit comprises the following components:

The kit also comprises a pulling hook, roll springs, copper flexible braids, field control mastic, adhesive tape, water sealing mastic,

lubricant, wipers, gloves and installation instructions.

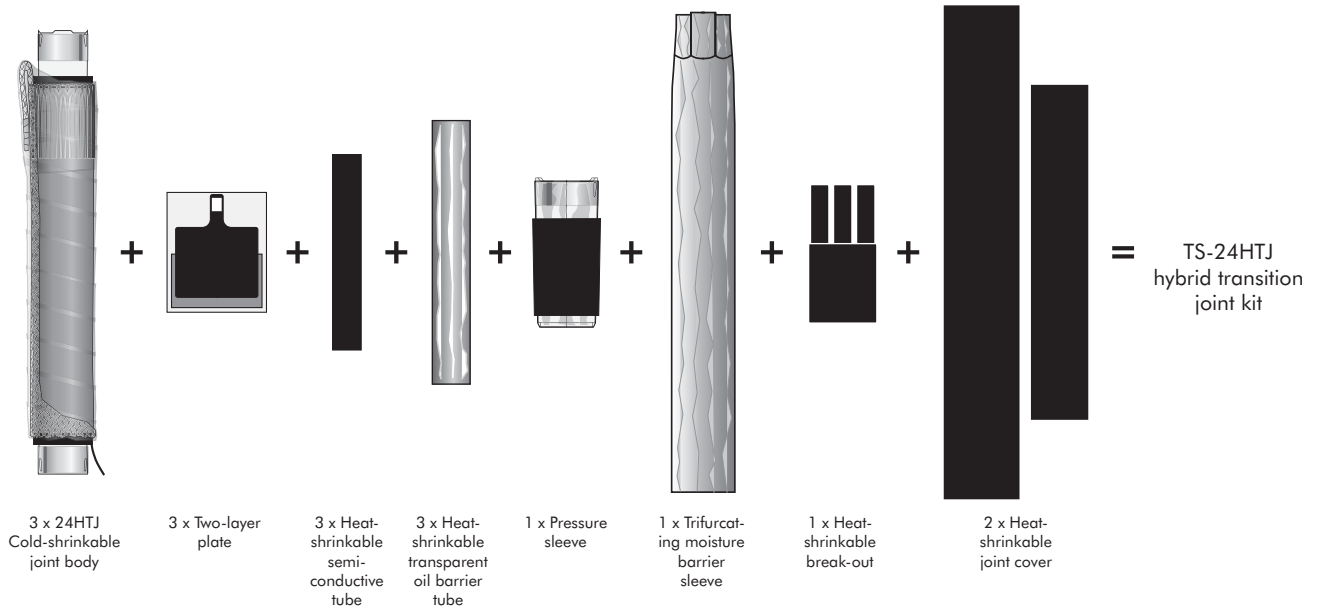

## Ordering instructions

Select the part number corresponding to the viscosity of the impregnated compound and verify the cable dimensions.

Please specify detailed cable information (type of screen and armour, if any - see Enquiry sheet p. 26).

Ordering part number	Conductor sizes (mm <sup>2</sup> ) (for paper insulated cables)								Dry insulated cable		Paper insulated cable (for information only)	
	35	50	70	95	120	150	185	240	300	Dia. over outer sheath (mm)	Dia. over core insulation (mm)	Dia. over paper insulation (mm)
	TS-24HTJ-1	TS-24HTJ-1								46 max	18 min	15 min
TS-24HTJ-2	TS-24HTJ-2								46 max	23 min	15 min	

### Example:

The three core individual screened, lead sheathed paper cable is 24 kV, 3 x 120 mm<sup>2</sup>, non-draining type and with armour. It must be jointed to three single core 24 kV, 120 mm<sup>2</sup> XLPE cables with

a copper wire screen (with a diameter over core insulation of 25.3 mm). Order a TS-24HTJ transition joint kit.

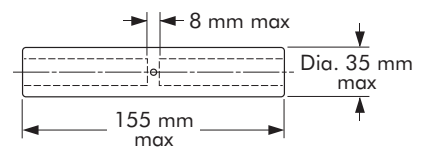

All types of conductor connectors can be used. The conductor connectors must be within the dimensions specified. An oil stop is mandatory for all types of conductor connectors.



For use with other cable types. Please contact our representative.

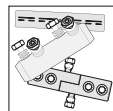

Can be supplied with all common types of conductor connectors

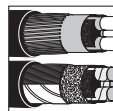

Different armour connections are available. Please contact our representative.



For use with individual lead sheathed cables: order -/3Pb

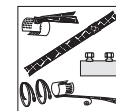

Different types of screen continuity kits can be supplied. Please contact our representative.

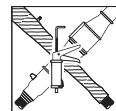

Resin injected and cast resin covers available. Please contact our representative.



## -/STOP STOP JOINTS

### Application

For insulating and sealing live ends of polymeric cable to be laid in air or directly buried. The product is fully screened and fully submersible.

### Technical characteristics

All joint housings are tested for AC withstand prior to leaving the factory.

**Up to 36 kV**

6/10 (12) kV  
6.35/11 (12) kV  
8.7/15 (17.5) kV  
12/20 (24) kV  
12.7/22 (24) kV  
18/30 (36) kV  
19/33 (36) kV

### 12CSJ/STOP Cold-shrinkable stop joint

The design of this product is based on the 12CSJ straight joint. The kit contains everything you need for the installation of one phase.

### Ordering instructions

Order a 12CSJ-2/STOP stop joint kit.

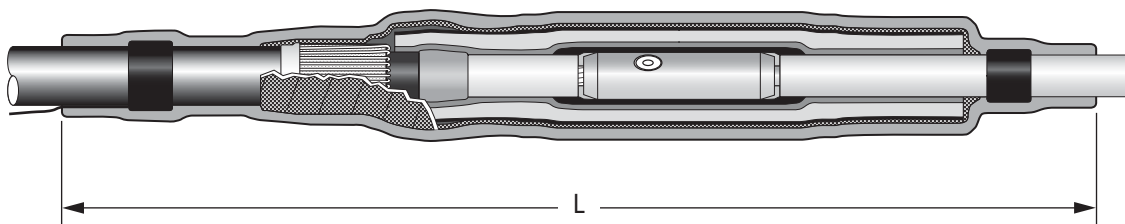

Cold-shrinkable stop joint type	L (mm)	Voltage Um (kV)	Diameter over outer sheath (mm)	Diameter over core insulation (mm)		Conductor sizes (mm <sup>2</sup> ) (for information only)	
			max	min	max	min	max
12CSJ-2/STOP	550	12	46	17	33	70	300

12/2009

## 24CSJ/STOP Cold-shrinkable stop joint

The design of this product is based on the 24CSJ straight joint.

The kit contains everything you need for the installation of one phase.

## Ordering instructions

Select the part number corresponding to the cable core insulation diameter.

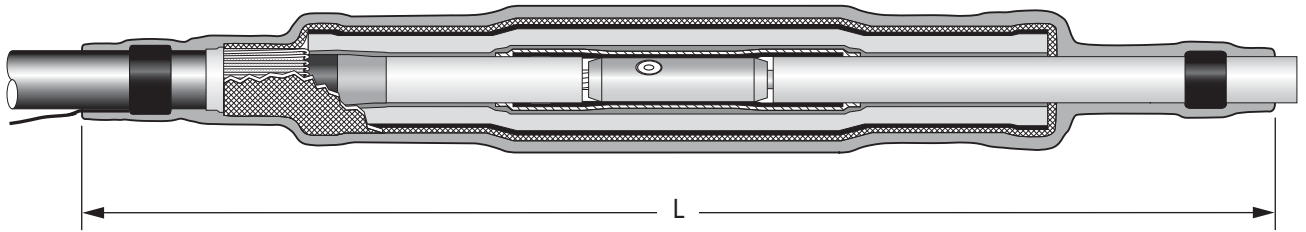

Cold-shrinkable straight joint type	L (mm)	Voltage $U_m$ (kV)	Diameter over outer sheath (mm)		Diameter over core insulation (mm)		Conductor sizes for 24 kV (mm <sup>2</sup> ) (for information only)	
			max	min	max	min	max	
24CSJ-1/STOP	750	24	46	18	30	35	185	
24CSJ-2/STOP	750	24	46	23	33	95	300	
24CSJ-3/STOP	850	24	57	30	54	240	630	

## 36CSSM/STOP Cold-shrinkable stop joint

The design of this product is based on the 36CSSM straight joint.

The kit contains everything you need for the installation of one phase.

## Ordering instructions

Select the part number corresponding to the cable core insulation diameter.

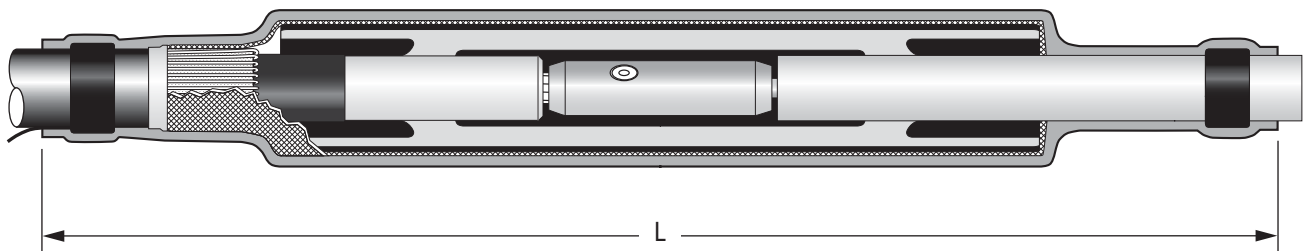

Cold-shrinkable straight joint type	Cover type	L (mm)	Voltage $U_m$ (kV)	Dia. over core insulation (mm)		Dia. over outer sheath (mm)	Conductor sizes for 36 kV (mm <sup>2</sup> ) (for information only)	
				min	max	max	min	max
36CSSM-2/CSC/STOP	Cold-shrinkable	750	42	27	40	48	50	240
36CSSM-3/CSC/STOP	Cold-shrinkable	850	42	37	50	57	300	500
36CSSM-3/HSS/STOP	Heat-shrinkable	850	42	37	60	75	300	800

## ENQUIRY SHEET

**Nexans Network Solutions N.V.**  
**Div. Euromold**

Zuid III - Industrielaan 12  
B-9320 EREMBODEGEM-AALST - BELGIUM

Tel.: +32 (0)53 850 220  
Fax: +32 (0)53 850 291  
E-Mail: sales.euromold@nexans.com

**Your company details:**

Company: .....

Address: .....

Tel.: .....

Fax: .....

E-Mail: .....

### I Cable Data

1. Cable type:  Single core  Three core
2. System voltage (kV):  3.6/6 (7.2)  12/20 (24)  20.8/36 (42)  
 6/10 (12)  12.7/22 (24)  Other: ..... / ..... (.....)  
 6.35/11 (12)  18/30 (36)  
 8.7/15 (17.5)  19/33 (36)
3. System current (A):  250  630  1250  
 400  800  Other: ..... A

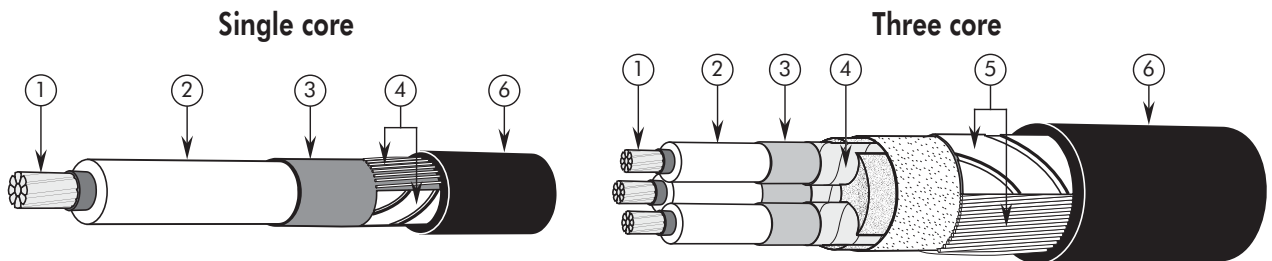

### 4. Cable description:

- ① Conductor material:  Al  Cu  
 Conductor cross section: ..... mm<sup>2</sup> (16 - 25 - 35 - 50 - 70 - 95 - 120 - 150 - 185 - 240 - 300 - 400 - 500 - 630 - 800 - 1000 mm<sup>2</sup>)
- ② Core insulation: - type:  XLPE  EPR  Paper  
 - diameter: ..... mm
- ③ Semi-conductive screen: - type:  Bonded  Easy strip  Fabric tape  
 - diameter (Optional): ..... mm
- ④ Metal screen type:  Al  Cu  Wire screen  Tape screen
- ⑤ Armour type:  No  SWA  STA
- ⑥ Outer sheath diameter: ..... mm

**Please fax to: +32 (0)53 850 291**

Please copy this page and use it for all enquiries to Nexans Network Solutions N.V. - Div. Euromold